

a 50-47

a 50-65

a 46-21

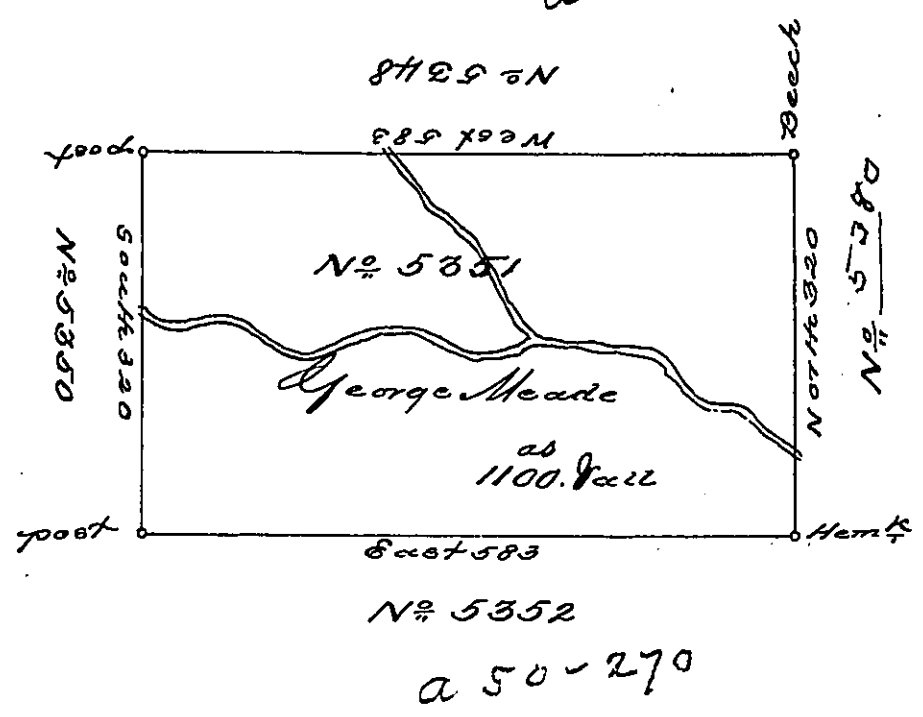

Situate on the waters of the West branch of Susquehanna in North<sup>d</sup> County, containing 1100 acres and the usual allowance for roads. Surveyed April 27<sup>th</sup> 1794 for George Meade in pursuance of a warrant N<sup>o</sup> 5351, dated 3<sup>rd</sup> March 1794.

John Canan D.S.

Daniel Brodhead Esq  
S.S.

IN TESTIMONY that the above is a copy of the original remaining on file in the Department of Internal Affairs of Pennsylvania, made conformably to an Act of Assembly approved the 16th day of February, 1833, I have hereunto set my Hand and caused the Seal of said Department to be affixed at Harrisburg, this first day of November 1898

James W. Fatta  
Secretary of Internal Affairs.